



# HS 2

Quick Guide | Kurzanleitung | Guide de démarrage rapide | Guida rapida | Instrucciones resumidas | Instruções resumidas | Beknopte gebruiksaanwijzing | Krótka instrukcja obsługi | Snabbguide | Kort vejledning | Pikaohje | Γρήγορος οδηγός | Kısa Kılavuz | Краткая инструкция | 快速指南 | 快速使用指南 | クイックガイド | 요약 설명서

**In the box**

Frequency caps  
MZC 2-1 MZC 2-2

Quick Guide Safety Guide

Headband

3.5 mm jack plug or 3-Pin connector

**Adjusting**

slightly bend

slightly bend

**Headband**

click!

**Setup**

3.5 mm jack plug 3-Pin connector

\*not included

**Use**

2-3 cm

Sennheiser electronic GmbH & Co. KG

Am Labor 1, 30900 Wedemark, Germany, www.sennheiser.com  
Printed in Germany, Publ. 09/21, 587483/A03

## Accessories

### Frequency cap

short cap:  
MZC 2-1



+ 2 dB

or

long cap:  
MZC 2-2



+ 4 dB



### Windshields

MZW 2\*



- 20 dB  
MZW 2\*

MZW 02\*

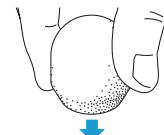

- 30 dB  
MZW 2\* + MZW 02\*

\*optional accessories

## Cleaning

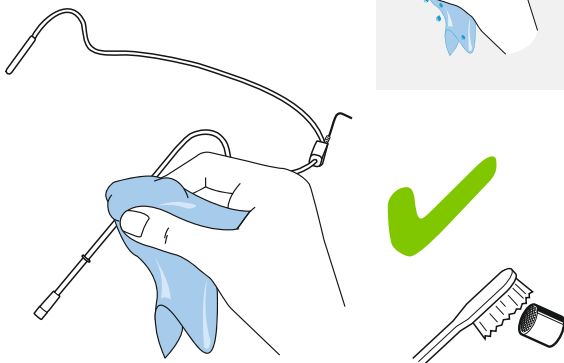

## Specifications

|                            |                     |
|----------------------------|---------------------|
| Pick-up pattern            | omni-directional    |
| Frequency response         | 20 - 20,000 Hz      |
| Sensitivity in free field  | 5 mV/Pa $\pm$ 3 dB  |
| Nominal impedance          | 1 k $\Omega$        |
| Min. terminating impedance | 4.7 k $\Omega$      |
| Equivalent noise level:    |                     |
| A-weighted                 | 28 dB               |
| CCIR-weighted              | 41 dB               |
| Max. sound pressure level  | 140 dB              |
| Power supply               | 7.5 V               |
| Connector                  | 3.5 mm jack   3-Pin |
| Cable length               | 1.6 m               |
| Diameter of microphone     | 4.8 mm              |
| Weight with headband       |                     |
| 3.5 mm jack                | 30.1 g              |
| 3-Pin                      | 28.9 g              |

## Frequency response

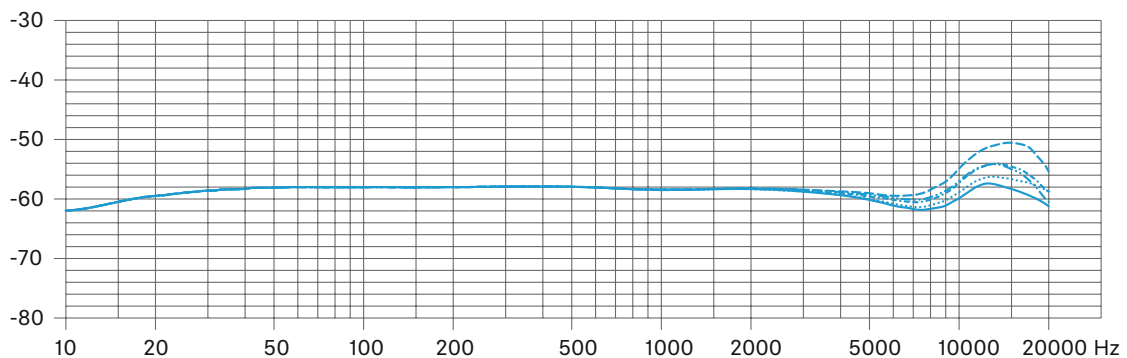

Frequency response curves of the microphone

Microphone placed in the corner of the mouth, distance to the mouth 3 cm

— capsule only

..... with MZC 2-1

----- with MZC 2-2

-.-.-.- with MZW 2

-.-.-.- with MZW 2 and MZW 02